

ASPECT™ DOUBLE HUNG

Standard Features

- 3¼" frame depth
 - SunShield® Vinyl
 - ¾" ComforTech™ DLA
 - Welded frame and sash construction
 - Roller-Tilt® balance system
 - Exterior glazing
 - Extruded sloped sill
 - Cove sash profile
 - Triple weatherstripping
 - Two surface mounted sculptured sweep locks and tilt latches
 - Dual vent locks
 - Roll formed half screen frame with BetterVue® screen mesh
- See price list for additional options



Assemblies

Side View

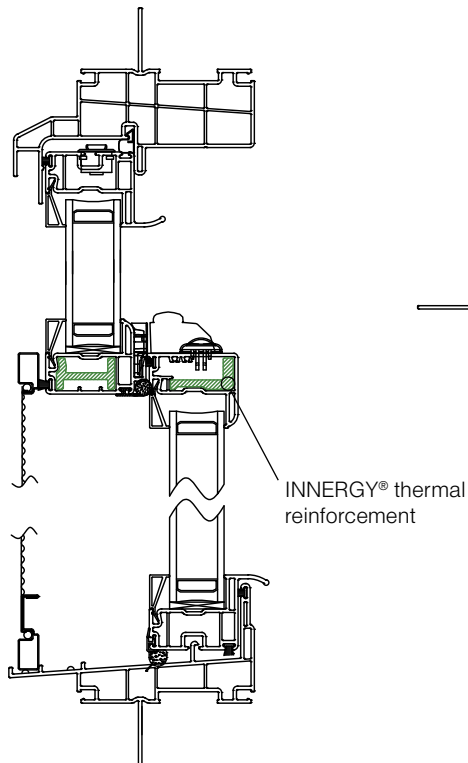

Top View

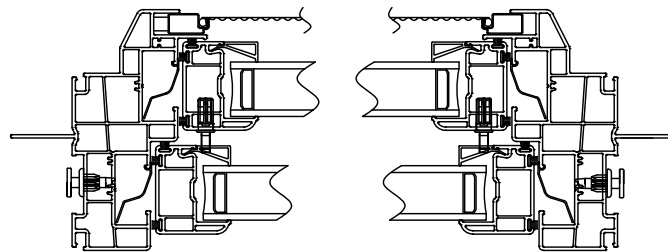

Aspect Double Hung 44" x 75"

Test	Test Specification	Results
Air	ASTM E 283	0.05 cfm/ft ² @ 25 mph
Water	ASTM E 547	7.52 psf
Structural	AAMA/WDMA/CSA 101/I.S.2/A440-8 and 11	R-DP50 142 mph

Test data is a result of sizes shown, configurations and lab conditions of a certified independent third party laboratory.

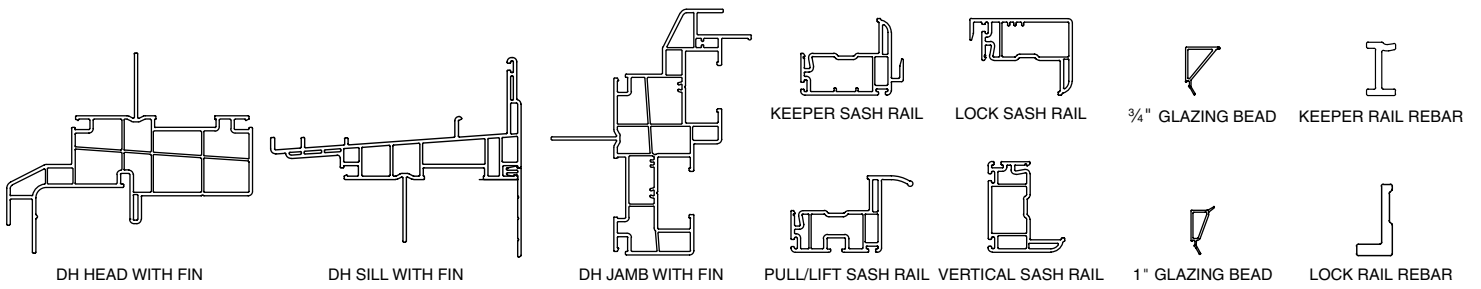

Accessories

Joining Mullion	Nail Fin	Brickmold Nail Fin w/J-Channel
<p>0° Mullion</p> <p>0.000</p>	<p>Integral Nail Fin</p> <p>1.125 1.188 2.062 2.353</p>	<p>Head & Jamb Brickmold</p> <p>0.800 0.980 2.225 3.016 1.891 0.657</p>
<p>Exterior Cover</p>	<p>Nail Fin with J-Channel</p>	<p>Sill Brickmold</p>
<p>Stucco Flange</p> <p>1.750 0.250 1.416 2.998</p>	<p>0.862 0.186 0.846 2.030 0.709 1.256 1.994 2.421</p>	<p>1.085 0.150 0.952 1.086 2.206 0.800 2.438 2.062</p>
<p>Accessory Groove Filler Strip</p>	<p>1/2" Drywall Return</p>	
	<p>1/2</p>	